

**PLEASE CHECK WWW.MOLEX.COM FOR LATEST PART INFORMATION**

**Part Number:** [0472710004](#)  
**Status:** **Active**  
**Overview:** [displayport](#)  
**Description:** Compressible Upper Cover for DisplayPort\* Cable Plug, Black, UL94V- 0

**Documents:**

[Drawing \(PDF\)](#) [RoHS Certificate of Compliance \(PDF\)](#)

**General**

|                |  |
|----------------|--|
| Product Family | Accessories                              |
| Series         | <a href="#">47271</a>                    |
| Comments       | This component's button can be depressed |
| Component Type | Cover                                    |
| MolexKits      | Yes                                      |
| Overview       | <a href="#">displayport</a>              |
| Product Name   | DisplayPort*                             |

**Physical**

|                               |                |
|-------------------------------|----------------|
| Breakaway                     | No             |
| Circuits (Loaded)             | N/A            |
| Circuits (maximum)            | 0              |
| Color - Resin                 | Black          |
| Gender                        | N/A            |
| Lock to Mating Part           | Yes            |
| Material - Resin              | ABS Alloy      |
| Number of Rows                | 0              |
| Packaging Type                | Bag            |
| Polarized to Mating Part      | Yes            |
| Temperature Range - Operating | -20°C to +85°C |

**Electrical**

|                               |      |
|-------------------------------|------|
| Current - Maximum per Contact | 0.5A |
|-------------------------------|------|

**Material Info**

**Reference - Drawing Numbers**

|               |              |
|---------------|--------------|
| Sales Drawing | SD-47271-004 |
|---------------|--------------|

DisplayPort\* is a Trademark of VESA

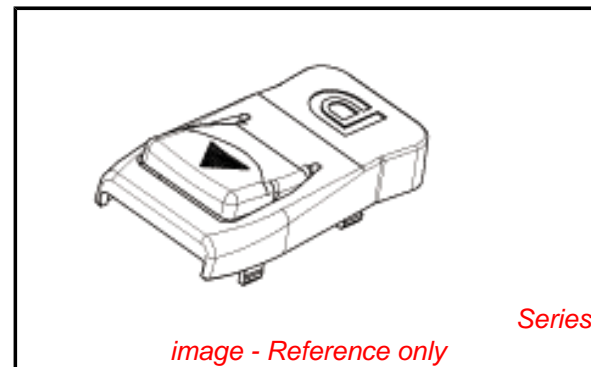

**EU RoHS**

**ELV and RoHS  
Compliant**

**REACH SVHC**

Not Reviewed

**Halogen-Free  
Status**

**Halogen-Free**

**Need more information on product  
environmental compliance?**

Email [productcompliance@molex.com](mailto:productcompliance@molex.com)

For a multiple part number RoHS Certificate of Compliance, [click here](#)

Please visit the [Contact Us](#) section for any non-product compliance questions.

**China RoHS**



**Search Parts in this Series**

[47271Series](#)

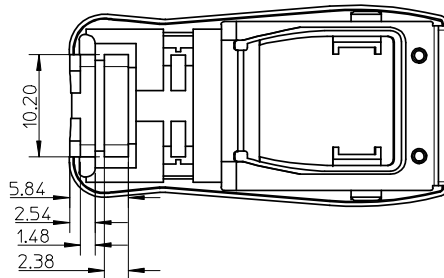
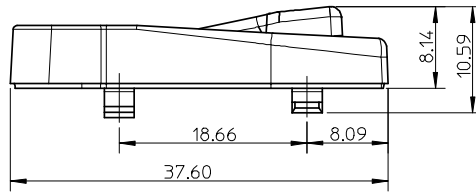
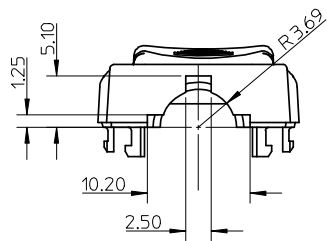
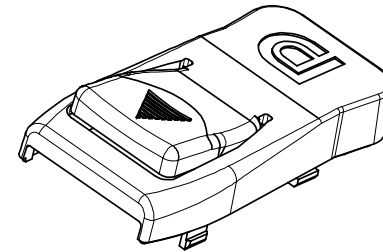
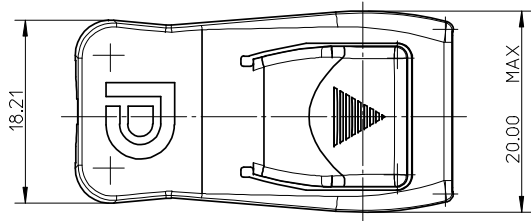

NOTES:

- 1.MATERIAL : HGH TEMPERATURE THERMAL PLASTIC, UL94HB, BLACK.
- 2.PRODUCT COMPLANT TO ROHS DIERTIVE 2002/95/EC AND ELV DIRECTIVE 2000/53/EC

|  |                               |                                       |  |                            |   |                     |                                   |                        |  |
|--|-------------------------------|---------------------------------------|--|----------------------------|---|---------------------|-----------------------------------|------------------------|--|
| NEW RELEASE<br>EC NO: SH2008-0288<br>DRW: HHE 2008/04/07<br>CHK: RZHANG 2008/04/08<br>APPR: HWANG 2008/04/25 | QUALITY SYMBOLS<br>▽=0<br>□=0 | GENERAL TOLERANCES (UNLESS SPECIFIED) |  | DIMENSION STYLE<br>MM ONLY |   | SCALE<br>2:1        | DESIGN UNITS<br>METRIC            | THIRD ANGLE PROJECTION |  |
|  |                               |                                       | mm   | INCH                       | DRAWN BY<br>QWFANG  | DATE<br>2006/09/05  | TITLE<br>COVER-UP FOR DISPLAYPORT |                        |  |
|  |                               | 4 PLACES                              | ± ---  | ± ---                      | CHECKED BY<br>I WANG  | DATE<br>2006/09/05  | MOLEX INCORPORATED                |                        |  |
|  |                               | 3 PLACES                              | ± ---  | ± ---                      | APPROVED BY<br>JNCHEN   | DATE<br>2006/09/05  |                                   |                        |  |
| 2 PLACES   | ± 0.2                         | ± ---                                 | MATERIAL NO.<br>47271-0004                           |                            | DOCUMENT NO.<br>SD-47271-004  | SHEET NO.<br>1 OF 2 |                                   |                        |  |
| 1 PLACE  | ± 0.2                         | ± ---                                 | DRAFT WHERE APPLICABLE MUST REMAIN WITHIN DIMENSIONS |                            | THIS DRAWING CONTAINS INFORMATION THAT IS PROPRIETARY TO MOLEX INCORPORATED AND SHOULD NOT BE USED WITHOUT WRITTEN PERMISSION |                     |                                   |                        |  |
| ANGULAR ± 2 °  |                               |                                       |  |                            |   |                     |                                   |                        |  |

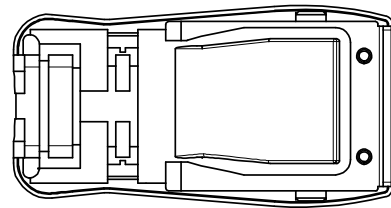
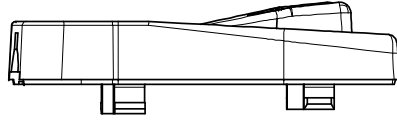
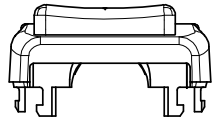
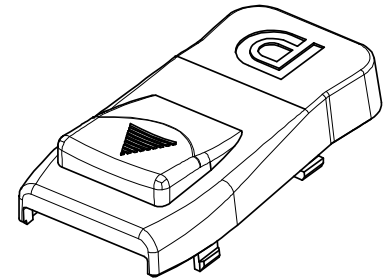
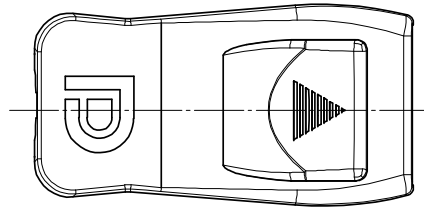

NOTES:

1. THIS COMPONENT'S BUTTON IS FIXED.
2. UNSPECIFIED DIMENSIONS ARE SAME AS 47271-0004.

|  |                          |                    |  |                                       |   |                            |                    |                                   |                        |                              |  |                     |  |
|--|--------------------------|--------------------|--|---------------------------------------|---|----------------------------|--------------------|-----------------------------------|------------------------|------------------------------|--|---------------------|--|
| SEE SHEET1<br>EC NO: SH2008-0288<br>DRWN: HHE<br>CHKD: RZHANG<br>APPR: HWANG | 2008/04/07<br>2008/04/25 | DESCRIPTION<br>REV | QUALITY SYMBOLS<br>▽=0<br>◻=0                        | GENERAL TOLERANCES (UNLESS SPECIFIED) |   | DIMENSION STYLE<br>MM ONLY |                    | SCALE<br>2:1                      | DESIGN UNITS<br>METRIC | THIRD ANGLE PROJECTION       |  |                     |  |
|  |                          |                    |  | mm                                    | INCH  | DRAWN BY<br>QWFANG         | DATE<br>2006/09/05 | TITLE<br>COVER-UP FOR DISPLAYPORT |                        |                              |  |                     |  |
|  |                          |                    | 4 PLACES   | ± ---                                 | ± ---   | CHECKED BY<br>IWANG        | DATE<br>2006/09/05 |                                   |                        |                              |  |                     |  |
|  |                          |                    | 3 PLACES   | ± ---                                 | ± ---   | APPROVED BY<br>JNCHEN      | DATE<br>2006/09/05 | MATERIAL NO.<br>47271-1004        |                        | DOCUMENT NO.<br>SD-47271-004 |  | SHEET NO.<br>2 OF 2 |  |
| 2 PLACES   | ± 0.2                    | ± ---              | DRAFT WHERE APPLICABLE MUST REMAIN WITHIN DIMENSIONS |                                       | THIS DRAWING CONTAINS INFORMATION THAT IS PROPRIETARY TO MOLEX INCORPORATED AND SHOULD NOT BE USED WITHOUT WRITTEN PERMISSION |                            |                    |                                   |                        |                              |  |                     |  |
| 1 PLACE  | ± 0.2                    | ± ---              | ANGULAR ± 2 °  |                                       |   |                            |                    |                                   |                        |                              |  |                     |  |